

# Ponoka



# County

Email Only To: [laura.friend@nrcb.ca](mailto:laura.friend@nrcb.ca)

December 5, 2019

NATURAL RESOURCES CONSERVATION BOARD  
19<sup>th</sup> Floor, Centennial Place  
250 – 5 Street SW  
CALGARY, AB  
T2P 0R4

ATTENTION: Laura Friend, Manager

Dear Laura:

RE: Board Review  
Kramer Dairy Ltd. – RA19016  
SE 2-43-25-W4

The Ponoka County Municipal Development Plan contains provisions to limit the establishment and expansion of CFO's on land within two miles of the Town of Ponoka. We understand and recognize that the Kramer Dairy, although 1.5 miles from the Town of Ponoka boundaries is grandfathered for continued operations.

The County supports condition #10 of authorization RA19016 regarding the earthen liquid manure storage. The proximity of the Dairy in relation to the Town Boundary and County residential acreages affirms the need to assess the environmental risk posed by the liquid manure storage (See attached Map #34)

Thank you for providing the Ponoka County an opportunity to file this rebuttal.

Sincerely yours,

A handwritten signature in blue ink, appearing to read "Tom Webber", written over a faint circular stamp or watermark.

Thomas G. Webber  
A.C.A.O.

TGW/lc

cc. Kramer Dairy Ltd.

4205 Highway #2A  
Ponoka, Alberta T4J 1V9  
Phone: (403) 783-3333  
Fax: (403) 783-6965

# Ponoka County Land Use Bylaw 7-08-LU

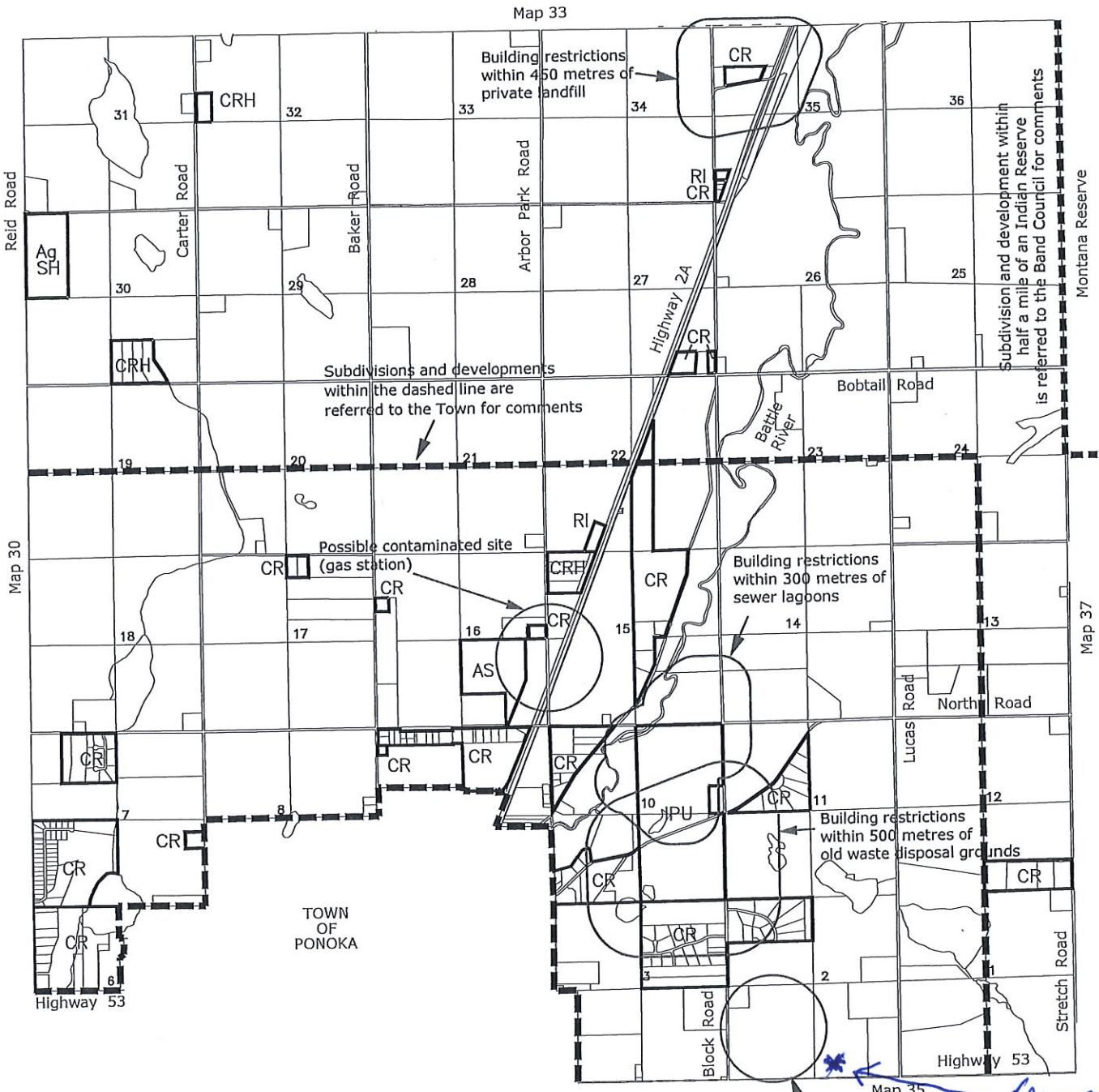

## Township 43-25 W4

Contaminated site (fence post treatment)

*KRAMER DAIRY*

- |                                    |                                 |                                   |
|------------------------------------|---------------------------------|-----------------------------------|
| AG Agricultural                    | LR Lake Resort                  | UR Urban Residential              |
| RA Restricted Agriculture          | REC Recreation                  | UC Urban Commercial               |
| AS Agriculture Smallholding        | RR Recreational Resort          | UI Urban Industrial               |
| CR Country Residential             | RVR Recreational Vehicle Resort | IPU Institutional and Public Uses |
| CRH Country Residential Hobby Farm | AIR Airport                     | PLC Prime Location Commercial     |
| WP Watershed Protection            | RI Rural Industrial             | DC Direct Control                 |
|                                    | RC Rural Commercial             | CLSA Chain Lakes Special Areas    |
|                                    |                                 | RMX Residential Mixed Use         |

All land is classified Agriculture unless marked otherwise

## Map 34

Revised Date: August 29, 2019