

Technical Document RA24027

Part 2 — Technical Requirements



Application under the Agricultural Operation Practices Act for a confined feeding operation, manure collection area, and/or manure storage facility(ies)

NRCB USE ONLY

☐ Approval



Registration



Authorization

☐ Amendment

Application number

RA24027

Legal land description

NE 19-44-20 W4M

APPLICATION DISCLOSURE

This information is collected under the authority of the Agricultural Operation Practices Act (AOPA), and is subject to the provisions of the Freedom of Information and Protection of Privacy Act. This information is public unless the NRCB grants a written request that certain sections remain private.

Any construction prior to obtaining an NRCB permit is an offence and is subject to enforcement action, including prosecution.

I, the applicant, or applicant's agent, have read and understand the statements above, and I acknowledge that the information provided in this application is true to the best of my knowledge.

FEB 14/24

Date of signing

Signature

Brian Goossen

Print name

Corporate name (if applicable)

GENERAL INFORMATION REQUIREMENTS

Proposed facilities: list all proposed confined feeding operation facilities and their dimensions. Indicate whether any of the proposed facilities are additions to existing facilities. (attach additional pages if needed)

Proposed facilities

Dimensions (m)
(length, width, and depth)

POULTRY BROILER BARN

3.3 x 18.3 x 76.2

TEMPORARY MANURE STORAGE

3 x 15 x 24

AO note: classified as temporary manure storage; does not require an AOPA permit

Existing facilities: list ALL existing confined feeding operation facilities and their dimensions

Existing facilities

Dimensions (m)
(length, width, and depth)

NRCB USE ONLY

BARN #1 POULTRY BARN

2.1 x 10.6 x 51.9

BARN #2 POULTRY BARN

3 x 14.6 x 36.5

TEMPORARY MANURE STORAGE

3 x 15 x 24

NRCB USE ONLY

Existing facilities confirmed

Part 2 — Technical Requirements

Application under the Agricultural Operation Practices Act for a confined feeding operation, manure collection area, and/or manure storage facility(ies)



NRCB | Natural Resources
Conservation Board

If a new facility is replacing an old facility, please explain what will happen to the old facility and when.

☒ N/A

Construction completion date for proposed facilities Nov 1/24

Additional information

Livestock numbers: Complete only if livestock numbers are different from what was identified in the Part 1 application. Note: if livestock numbers increase in your Part 2 application, a new Part 1 application must be submitted which may result in a loss of priority for minimum distance separation (MDS).

Livestock category and type (Available in the Schedule 2 of the Part 2 Matters Regulation)	Permitted number	Proposed increase or decrease in number (if applicable)	Total
CATEGORY D, Broilers	18,300	23,000	41,300
	17,400	23,900	
AO note: "Permitted livestock numbers" altered to reflect the current permitted animal numbers for the existing CFO. A capacity determination was done in conjunction with Authorization RA12033.			

Part 2 – Technical Requirements

Application under the Agricultural Operation Practices Act for a confined feeding operation, manure collection area, and/or manure storage facility(ies)



DECLARATION AND ACKNOWLEDGMENT OF APPLICANT CONCERNING WATER ACT LICENCE

issued by Alberta Environment and Protected Areas (EPA) for a confined feeding operation (CFO)

Date and sign one of the following four options

OPTION 1: Applying through the NRCB for both the AOPA permit and the Water Act licence

I **DO** want my water licence application coupled to my AOPA permit application.

Signed this ____ day of _____, 20____.

Signature of Applicant or Agent

OPTION 2: Processing the AOPA permit and Water Act licence separately

1. I (we) acknowledge that the CFO will need a new water licence from EPA under the *Water Act* for the development or activity proposed in this AOPA application.
2. I (we) request that the NRCB process the AOPA application **independently** of EPA's processing of the CFO's application for a water licence.
3. In making this request, I (we) recognize that, if this AOPA application is granted by the NRCB, the NRCB's decision will not be considered by EPA as improving or enhancing the CFO's eligibility for a water licence under the *Water Act*.
4. I (we) acknowledge that any construction or actions to populate the CFO with livestock pursuant to an AOPA permit in the absence of a *Water Act* licence will **not** be relevant to EPA's consideration of whether to grant the *Water Act* licence application.
5. I (we) acknowledge that any such construction or livestock populating will be at the CFO's sole risk if the *Water Act* licence application is denied or if the operation of the CFO is otherwise deemed to be in violation of the *Water Act*. This risk includes being required to depopulate the CFO and/or to cease further construction, or to remove "works" or "undertakings" (as defined in the *Water Act*).
6. **AS RELEVANT:** I (we) acknowledge that the CFO is located in the South Saskatchewan River Basin and that, pursuant to the *Bow, Oldman and South Saskatchewan River Basin Water Allocation Order* [Alta. Reg. 171/2007], this basin is currently closed to new surface water allocations.
7. **Provide:** Water licence application number(s) _____

Signed this ____ day of _____, 20____.

Signature of Applicant or Agent

OPTION 3: Additional water licence not required

1. I (we) declare that the CFO will not need a new licence from EPA under the *Water Act* for the development or activity proposed in this AOPA application.
2. **Provide:** Water license number(s) or water conveyance agreement details _____

Signed this ____ day of _____, 20____.

Signature of Applicant or Agent

Part 2 — Technical Requirements



Application under the *Agricultural Operation Practices Act* for a confined feeding operation, manure collection area, and/or manure storage facility(ies)

OPTION 4: Uncertain if Water Act licence is needed; acknowledgement of risk (for existing CFOs only)

1. At this time, I (we) do not know whether a new water licence is needed from EPA under the *Water Act* for the development or activity proposed in this AOPA application.
2. If a new *Water Act* licence is needed, I (we) request that the NRCB process the AOPA application **independently** of EPA's processing of the CFO's application for a water licence.
3. In making this request, I (we) recognize that, if this AOPA application is granted by the NRCB, the NRCB's decision will not be considered by EPA as improving or enhancing the CFO's eligibility for a water licence under the *Water Act*.
4. I (we) acknowledge that any construction or actions to populate the CFO with additional livestock pursuant to an AOPA permit in the absence of a *Water Act* licence will **not** be relevant to EPA's consideration of whether to grant my *Water Act* licence application, if a new water licence is needed.
5. I (we) acknowledge that any such construction or livestock increase will be at the CFO's sole risk if the *Water Act* licence application is denied or if the operation of the CFO is otherwise deemed to be in violation of the *Water Act*. This risk includes being required to depopulate the CFO and/or to cease further construction, or to remove "works" or "undertakings" (as defined in the *Water Act*).
6. **AS RELEVANT:** I (we) acknowledge that the CFO is located in the South Saskatchewan River Basin and that, pursuant to the *Bow, Oldman and South Saskatchewan River Basin Water Allocation Order* [Alta. Reg. 171/2007], this basin is currently closed to new surface water allocations.
7. **Provide:** Water license number(s) or water conveyance agreement details _____

Signed this 15 day of FEB, 2024.

Signature of Applicant or Agent

Google Maps

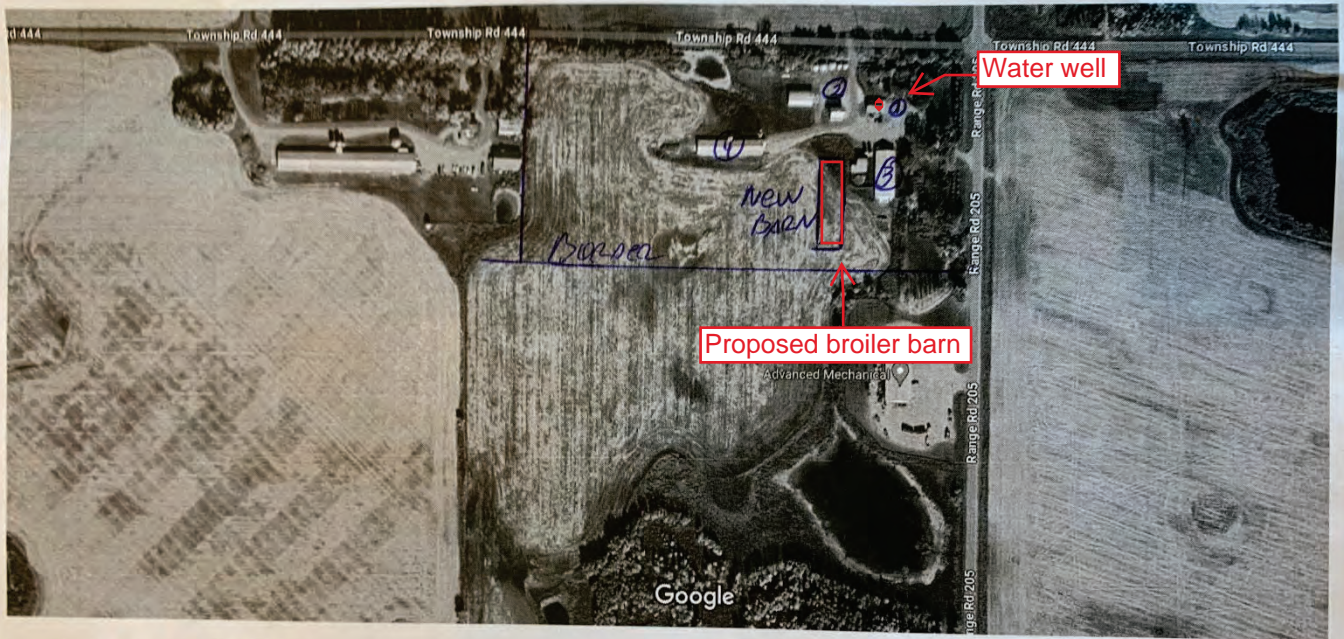

Imagery ©2024 Airbus, CNES / Airbus, Maxar Technologies, Map data ©2024 50 m

- 1 house & well
- 2 shops
- 3 barn
- 4 barn

Google Maps

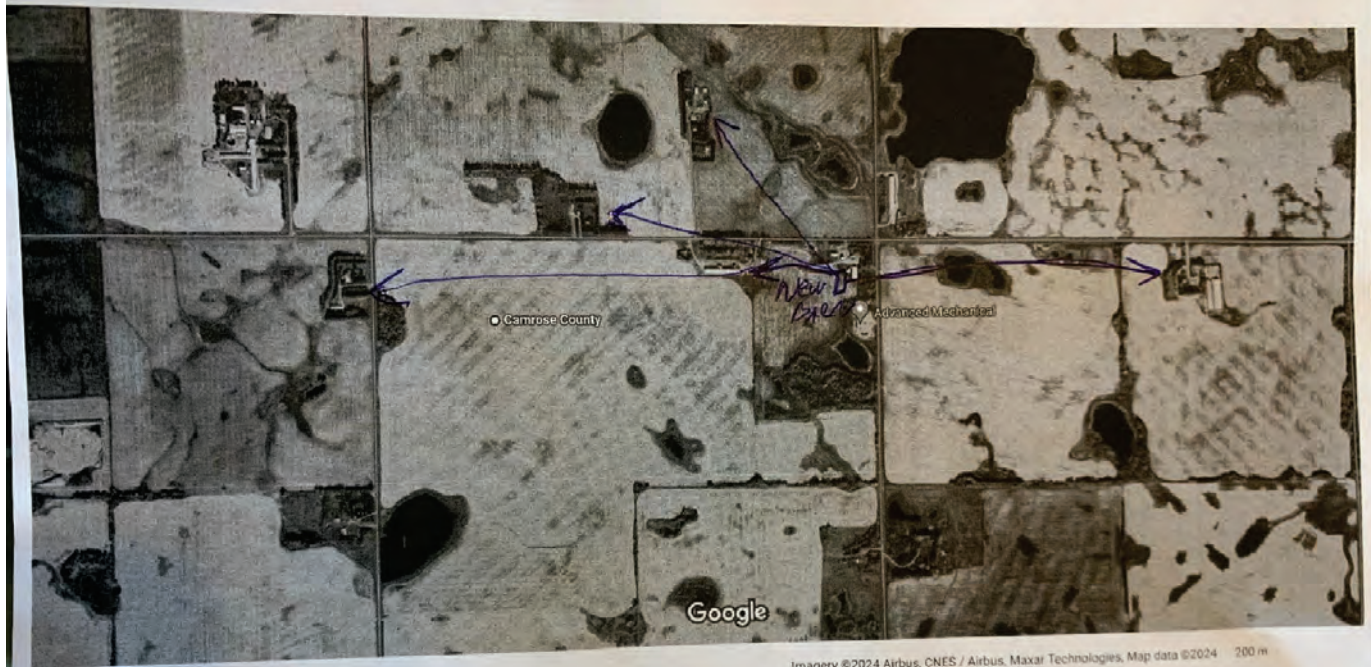

Imagery ©2024 Airbus, CNES / Airbus, Maxar Technologies, Map data ©2024 200 m

Live traffic

Fast  Slow

Part 2 — Technical Requirements

Application under the Agricultural Operation Practices Act for a confined feeding operation, manure collection area, and/or manure storage facility(ies)

GENERAL ENVIRONMENTAL INFORMATION

(complete this section for the worst case of the existing facility which is the closest to water bodies or water wells and for each of the proposed facilities)
Facility description / name (as indicated on site plan)

Existing: Barn 1 & 2

Proposed 1: Barn 3

Proposed 2: _____

Proposed 3: _____

Facility and environmental risk information		Facilities				NRCB USE ONLY	
		Existing	Proposed 1	Proposed 2	Proposed 3	Meets requirements	Comments
Flood plain information	What is the elevation of the floor of the lowest manure storage or collection facility above the 1:25 year flood plain or the highest known flood level?	<input type="checkbox"/> > 1 m <input checked="" type="checkbox"/> ≤ 1 m	<input type="checkbox"/> > 1 m <input checked="" type="checkbox"/> ≤ 1 m	<input type="checkbox"/> > 1 m <input type="checkbox"/> ≤ 1 m	<input type="checkbox"/> > 1 m <input type="checkbox"/> ≤ 1 m	<input checked="" type="checkbox"/> YES <input type="checkbox"/> NO <input type="checkbox"/> YES with exemption	>1m confirmed
	Surface water information						
Surface water information	How many springs are within 100 m of the manure storage facility or manure collection area?	0	0			<input checked="" type="checkbox"/> YES <input type="checkbox"/> NO <input type="checkbox"/> YES with exemption	None, confirmed on site
	How many water wells are within 100 m of the manure storage facility or manure collection area?	0	0			<input checked="" type="checkbox"/> YES <input type="checkbox"/> NO <input type="checkbox"/> YES with exemption	Well is inside the house ~105 m from proposed barn
	What is the shortest distance from the manure collection or storage facility to a surface water body? (e.g., lake, creek, slough, seasonal)	45m	45m			<input checked="" type="checkbox"/> YES <input type="checkbox"/> NO <input type="checkbox"/> YES with exemption	Slough ~109m NW of proposed barn
Groundwater information	What is the depth to the water table?	2m	2m			<input checked="" type="checkbox"/> YES <input type="checkbox"/> NO <input type="checkbox"/> YES with exemption	>2m
	What is the depth to the groundwater resource/aquifer you draw water from?	45m	45m			<input checked="" type="checkbox"/> YES <input type="checkbox"/> NO <input type="checkbox"/> YES with exemption	36.6m using WWID 137914

Additional information (attach supporting information, e.g. borehole logs, records, etc. you consider relevant to your application)

Part 2 – Technical Requirements

Application under the *Agricultural Operation Practices Act* for a confined feeding operation, manure collection area, and/or manure storage facility(ies)

NRCB USE ONLY

WATER WELL AND SURFACE WATER INFORMATION

Well IDs: 137914 _____

Surface water related concerns from directly affected parties or referral agencies: ☐ YES ☒ NO

Groundwater related concerns from directly affected parties or referral agencies: ☐ YES ☒ NO

Water wells ☒ N/A

If applicable, exemption for 100 m distance requirements applied: ☐ YES ☐ NO Condition required: ☐ YES ☐ NO

Surface water ☒ N/A

If applicable, exemption for 30 m distance requirements applied: ☐ YES ☐ NO Condition required: ☐ YES ☐ NO

Water Well Exemption Screening Tool ☒ N/A

Water Well ID	Preliminary Screening Score	Secondary Screening Score	Facility

Groundwater or surface water related comments:

Part 2 — Technical Requirements

Application under the *Agricultural Operation Practices Act* for a confined feeding operation, manure collection area, and/or manure storage facility(ies)

NRCB USE ONLY

ENVIRONMENTAL RISK SCREENING INFORMATION

ERST for proposed facilities

Facility	Groundwater score	Surface water score	File number
New broiler barn	Low	Low	RA24027

ERST for existing facilities

Facility	Groundwater score	Surface water score	File number
East broiler barn	Low	Low	RA12033

ERST related comments:

Part 2 — Technical Requirements

Application under the Agricultural Operation Practices Act for a confined feeding operation, manure collection area, and/or manure storage facility(ies)

DISTANCE OF ANY MANURE STORAGE FACILITY (EXISTING OR PROPOSED) TO NEIGHBOURING RESIDENCES

Neighbour name(s)	Legal land description	Distance (m)	NRCB USE ONLY			
			Zoning (LUB) category	MDS category (1-4)	Distance (m)	Waiver attached (if required)
REG SIEMENS	NE-19-44-W4	100	Agriculture	1		Yes
TREVOR GOOSSE	NE-20-44-20-W4	1204	Ag	1		n/a
KEVIN WESTFALL	SE 20-44-20-W4	804	Ag	1		n/a
LOGAN TOEWS	SW 30-44-20-W4	804	Ag	1		n/a
NOAH TOEWS	NE 24-44-20-W4	1004	Ag	1		n/a

LAND BASE FOR MANURE AND COMPOST APPLICATION (complete only if an increase in livestock or manure production will occur)

Name of land owner(s)*	Legal land description	Usable area** (ha)	Soil zone ***	NRCB USE ONLY	
				Usable area (ha)	Agreement attached (if required)
BRAD GOOSSE	NW-20-44-20-W4	55.4	BLACK	55.4	N/A
BRAD GOOSSE	NE-19-44-20-W4	28.35	BLACK	28.3	
BRAD GOOSSE	SW-19-44-20-W4	28.35	BLACK	28.3	
Total				112.1	

* If you are **not** the registered landowner, you must attach copies of land use agreements signed by all landowners.

** Available manure spreading area (excluding setback areas from residences, common bodies of water, water wells, etc. as identified in Agdex 096-5 Manure Spreading Regulations)

*** Brown, dark brown, black, grey wooded, or irrigated

Additional information (attach any additional information as required)

Minimum Distance Separation (MDS) Waiver (declaration)

Applicant information

NRCB application number: RA24027

Operator/operation name: Dan Goossen

Address: Rd #2 New Norway AB Postal Code: T0B3L0

Legal land location of confined feeding operation: NE-19-44-20-W4TH

I have requested the residence owner(s) named below to waive the required minimum distance separation (MDS) to their residence for the *Agricultural Operation Practices Act* (AOPA) permit application identified above. In making this request, I have provided the owner(s) with an opportunity to review my permit application and a copy of the Natural Resources Conservation Board (NRCB) Fact Sheet "Minimum Distance Separation (MDS) Waivers" available on the NRCB website at www.nrcb.ca. I have also explained:

- The MDS requirement set out in section 3 of the Standards and Administration Regulation of AOPA. I have advised the owner(s) that section 3(6)(a) of the Standards and Administration Regulation allows this requirement to be waived by the owners of residences, if they agree in writing to grant a waiver;
- That my proposed development does not meet the required MDS to the owner's residence; and,
- That this waiver applies only to this application as described. An increase in livestock capacity, annual manure production, level of odour production, change to the site plan or change to a facility that would increase the MDS would require a new waiver.

Following is a summary of the proposed development:

- The current scope of my confined feeding operation (CFO), including the type, number, and category of livestock, if any, is:

BROILER CHICKENS 41,300

- My application for a new AOPA permit proposes the following changes to the existing livestock category, type and/or capacity at my CFO:

FOR THE INCREASE OF MY POULTRY OPERATION
TO 23,000 CHICKENS

- The proposed new CFO facility(ies), or changes to the existing CFO facilities, including manure storage, manure storage volume and any other pertinent details, if any, are (attach a site layout plan if available):

NEW POULTRY BARN & TEMPORARY MANURE STORAGE

I the applicant understand that the waiver is not valid unless ALL registered owners of the residence sign this document

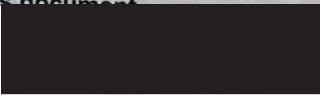
Permit Applicant: 

Date: MAY 23/24

Signature

Residence owner(s) to initial: B.G.

Minimum Distance Separation (MDS) Waiver (declaration)

Residence owner(s) information

ALL Names on land title:

Reg & Connie Siemens

Legal land location of residence(s):

W¹/₂, NE¹/₄, 19-44-20-W4

Telephone number(s)¹

mail address(es)¹:

Address(es)¹ and Postal code(s)¹:

¹ Please note that personal contact information is for NRCB use ONLY and not publicly released

I am/we are the legal landowner(s) of a residence(s) located at the above noted legal land location/address:

- I/we have read the NRCB Fact Sheet "Minimum Distance Separation (MDS) Waivers";
- I/we have discussed this application with the applicant and understand its potential impacts to our residence(s);
- I/we understand that the application **does not** meet the MDS requirement to my/our residence(s), under the *Agricultural Operation Practices Act* (AOPA);
- **I/we understand that this waiver is not valid unless signed by ALL parties identified on the land title as owners;**
- **I/we are not obligated to waive the MDS requirement to our residence(s);**
- I/we understand that if I/we choose to waive the MDS requirement, I/we can revoke the waiver, by providing written notice to the NRCB approval officer, as set out in the "Minimum Distance Separation (MDS) Waivers" Fact Sheet; and
- I/we understand that this waiver is a public document.

Having considered my/our rights, I/we hereby waive the MDS requirement to my/our residence, with respect to

Application number RA24027

Signatures of all residence owner(s) on title

Reginald Siemens Connie Siemens

Printed names of all residence owner(s) on title

Date:

May 23, 2024

Part 2 – Technical Requirements

Application under the *Agricultural Operation Practices Act* for a confined feeding operation, manure collection area, and/or manure storage facility(ies)

NRCB USE ONLY

MINIMUM DISTANCE SEPARATION

Methods used to determine distance (if applicable): Aerial photography

Margin of error (if applicable): +/- 5m

Requirements (m): Category 1: 180 Category 2: 241 Category 3: 301 Category 4: 481

Technology factor: ☐ YES ☒ NO

Expansion factor: ☐ YES ☒ NO

MDS related concerns from directly affected parties or referral agencies: ☐ YES ☒ NO

This application includes 1 MDS waiver

LAND BASE FOR MANURE AND COMPOST APPLICATION

Land base required: 83.8 ha

Land base listed: 112.1 ha

Area not suitable: N/A

Available area: 112.1 ha

Requirement met: ☒ YES ☐ NO

Land spreading agreements required: ☐ YES ☒ NO

Manure management plan: ☐ YES ☒ NO

If yes, plan is attached: ☐

PLANS

Submitted and attached construction plans: ☐ YES ☒ NO

Submitted aerial photos: ☒ YES ☐ NO

Submitted photos: ☐ YES ☒ NO

GRANDFATHERING

Already completed: ☒ YES ☐ NO ☐ N/A

If already completed, see RA12033

Part 2 — Technical Requirements

Application under the Agricultural Operation Practices Act for a confined feeding operation, manure collection area and/or manure storage facility(ies)

SOLID MANURE, COMPOST, & COMPOSTING MATERIALS: Barns, feedlots, & storage facilities - Compacted soil liner

(complete a copy of this section for **EACH** barn, feedlot, and storage facility for solid manure, composting materials, or compost with a compacted soil liner)

Facility description / name (as indicated on site plan)

1. Broiler barn
2. _____

Manure storage capacity

	Length (m)	Width (m)	Depth below grade to the bottom of the liner (m)	NRCB USE ONLY Estimated storage capacity (m ³)
1.	76.2	18.3	0	
2.				
TOTAL CAPACITY				

☒ I plan to use a short-term solid manure storage (STMS) as part of my manure storage and handling plan for this CFO. (The AOPA requirements for STMS are set out in the NRCB [Short-Term Solid Manure Storage Requirements Fact Sheet](#).)

Surface water control systems

Describe the run-on and runoff control system

Drainage will be done to drain water away from CFO

Liner protection

Describe how the physical integrity of the liner will be maintained

Liner will be checked for cracks & maintained

NRCB USE ONLY

Requirements met: ☒ YES ☐ NO

Part 2 — Technical Requirements

Application under the Agricultural Operation Practices Act for a confined feeding operation, manure collection area and/or manure storage facility(ies)

SOLID MANURE, COMPOST, & COMPOSTING MATERIALS: Barns, feedlots, & storage facilities - Concrete liner (cont.)

Concrete liner details

Concrete thickness <i>WALLS 8" X 24" PILING 96" FLOOR 5"</i>	Method of sulphate protection: <i>TYP 50</i>
Concrete strength <i>27 MPa</i>	Concrete reinforcement size and spacing <i>10mm REBAR OR 15' GRID</i>

Concrete requirements can be found in Technical Guideline Agdex 096-93

Guideline minimums:
Solid manure: 25MPa (D)
Solid manure (wet): 30MPa (C)
Method of sulphate protection:
Type 50 or Type 10 with fly ash or equivalent

NRCB USE ONLY

Requirements met:	<input checked="" type="checkbox"/> YES <input type="checkbox"/> NO
Condition required:	<input checked="" type="checkbox"/> YES <input type="checkbox"/> NO
Report attached:	<input type="checkbox"/> YES <input checked="" type="checkbox"/> NO

Additional information (attach as required)

NRCB USE ONLY

Nine month manure storage volume requirements met ☐ YES ☒ YES With STMS ☐ NO

Depth to water table: *> 2m* Requirements met: ☒ YES ☐ NO

Depth to Uppermost groundwater resource: *36.6 m* Requirements met: ☒ YES ☐ NO

ERST completed: ☒ see ERST page for details

Surface water control systems

Requirements met: ☒ YES ☐ NO Details/comments:

Concrete liner details

A condition will be included requiring the concrete liner to meet the specifications for category D (solid manure - dry) in Technical Guideline Agdex 096-93 "Non-Engineered Concrete Liners for Manure Collection and Storage Areas".

Leakage detection system required: ☐ YES ☒ NO If yes, please explain why.

Last updated February 26, 2021

Part 2 — Technical Requirements

Application under the *Agricultural Operation Practices Act* for a confined feeding operation, manure collection area, and/or manure storage facility(ies)

NRCB USE ONLY

ALL SIGNATURES IN FILE

☒ YES ☐ NO

DATES OF APPROVAL OFFICER SITE VISITS

June 5, 2024	

CORRESPONDENCE WITH MUNICIPALITIES AND REFERRAL AGENCIES

Date deeming letters sent: June 4, 2024

Municipality: Camrose County

☒ letter sent ☒ response received ☒ written/email ☐ verbal ☐ no comments received

Alberta Health Services: ☒ N/A

☐ letter sent ☐ response received ☐ written/email ☐ verbal ☐ no comments received

Alberta Environment and Parks: ☐ N/A

☒ letter sent ☐ response received ☐ written/email ☐ verbal ☒ no comments received

Alberta Transportation: ☒ N/A

☐ letter sent ☐ response received ☐ written/email ☐ verbal ☐ no comments received

Alberta Regulatory Services: ☒ N/A

☐ letter sent ☐ response received ☐ written/email ☐ verbal ☐ no comments received

Other: Battle River Power Co-op, Battle River Natural Gas Co-op Ltd. ☐ N/A

☒ letter sent ☐ response received ☐ written/email ☐ verbal ☒ no comments received

Other: _____ ☐ N/A

☐ letter sent ☐ response received ☐ written/email ☐ verbal ☐ no comments received